

INSTRUCTIONS MANUAL FOR INTERNAL SLEEVE REPLACING / INSTRUCTIONS CHANGEMENT BAGUE INTERNE CURSEUR EMERILLON

MODELES : C14 RA, C24 RA, C25 RA, C26 RA ,C33 RA, C34 RA, C39 RA, C47 RA, C53 RA - REP 48 / 49

Content / Contenu :

The content depends of the references and quantities ordered / *Le contenu varie selon les pièces et les quantités commandées*

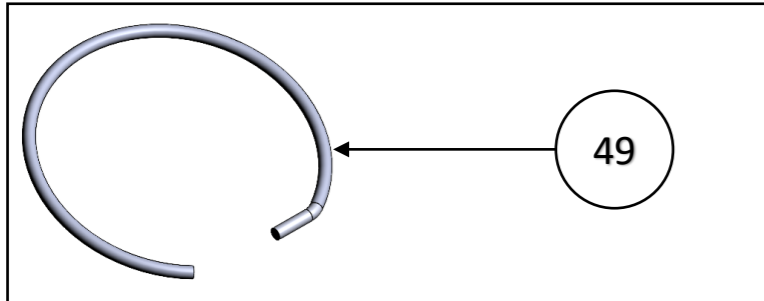
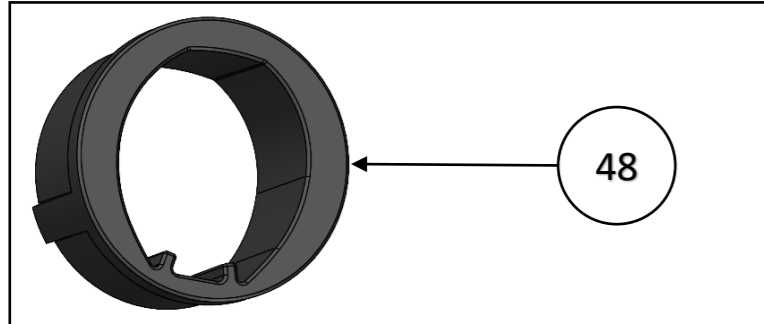

Tools / Outils



Step 1 / Étape 1

Only remove parts that need to be replaced. Use the tools carefully to avoid damage to the product. Remove the clips with a flat screw driver.

Ne retirer que les pièces qui nécessite d'être changées. Utiliser les outils avec attention pour ne pas détériorer le produit. Retirer les joncs à l'aide d'un tournevis plat

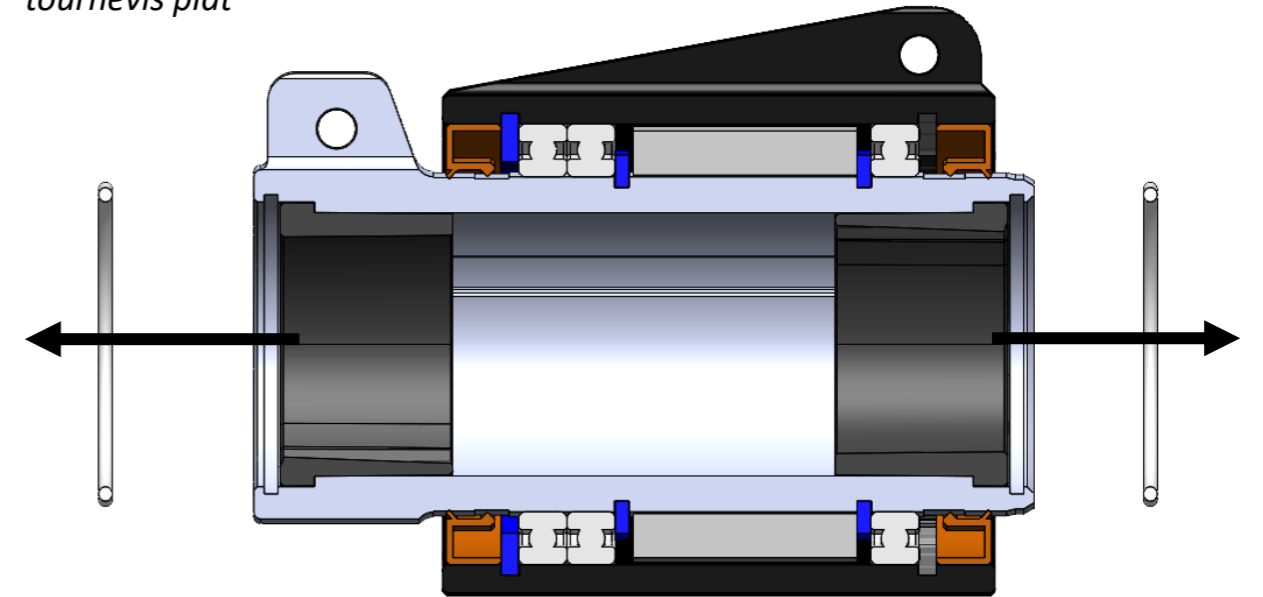

Step 2 / Étape 2

Remove the internal sleeve

Retirer les bagues internes

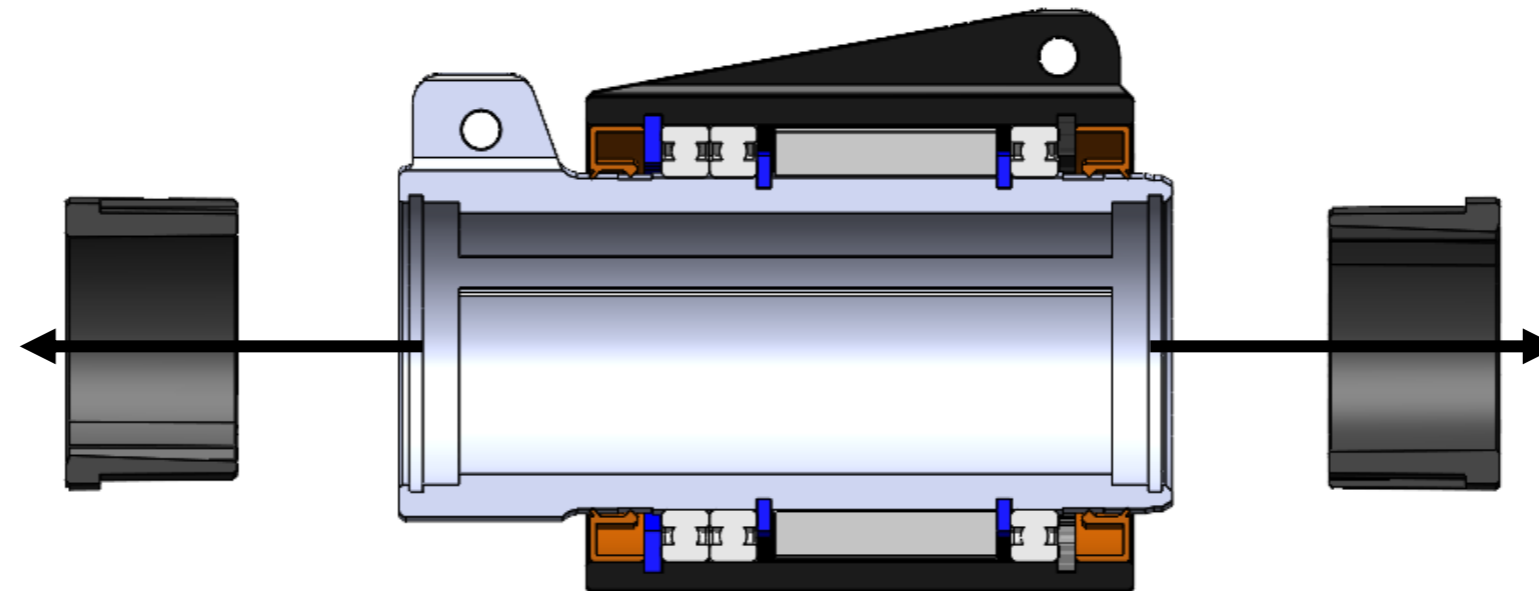

INSTRUCTIONS MANUAL FOR INTERNAL SLEEVE REPLACING / INSTRUCTIONS CHANGEMENT BAGUE INTERNE CURSEUR EMERILLON

MODELES : C14 RA, C24 RA, C25 RA, C26 RA ,C33 RA, C34 RA, C39 RA, C47 RA, C53 RA - REP 48 / 49

Step 3 / Étape 3

Fit the new internal sleeves

Emmancher les nouvelles bagues internes

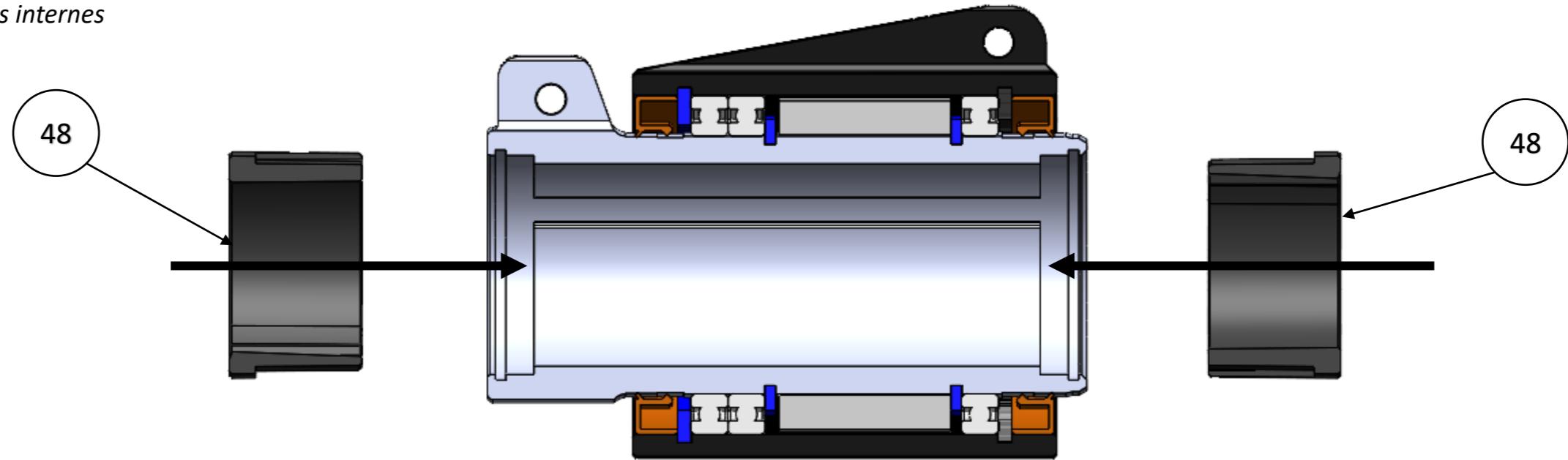

Step 4 / Étape 4

Fit the new clips

Emmancher les nouveaux joncs

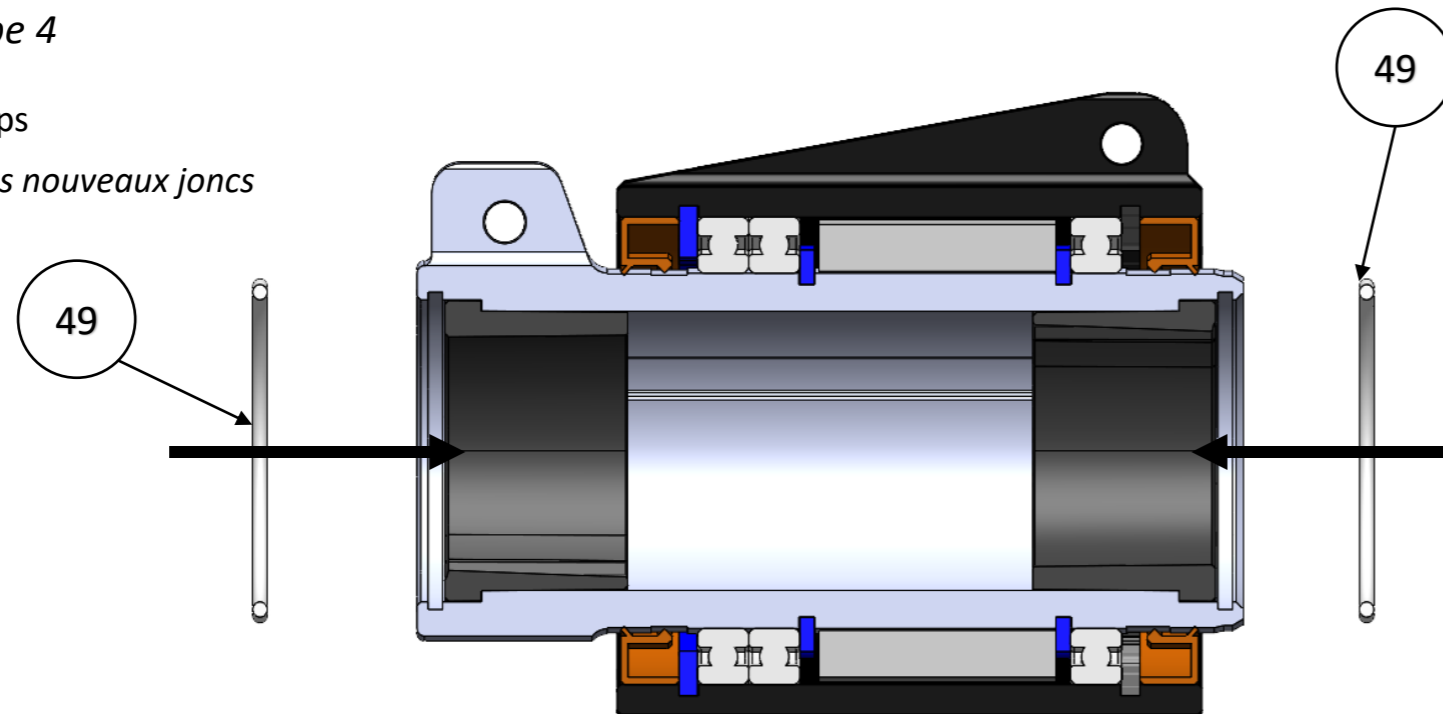

FACNOR – IMPORTANT

**Imperative to respect ring's and inner sleeve's position as shown
Position bague et anneau à respecter impérativement comme ci-dessous**

